

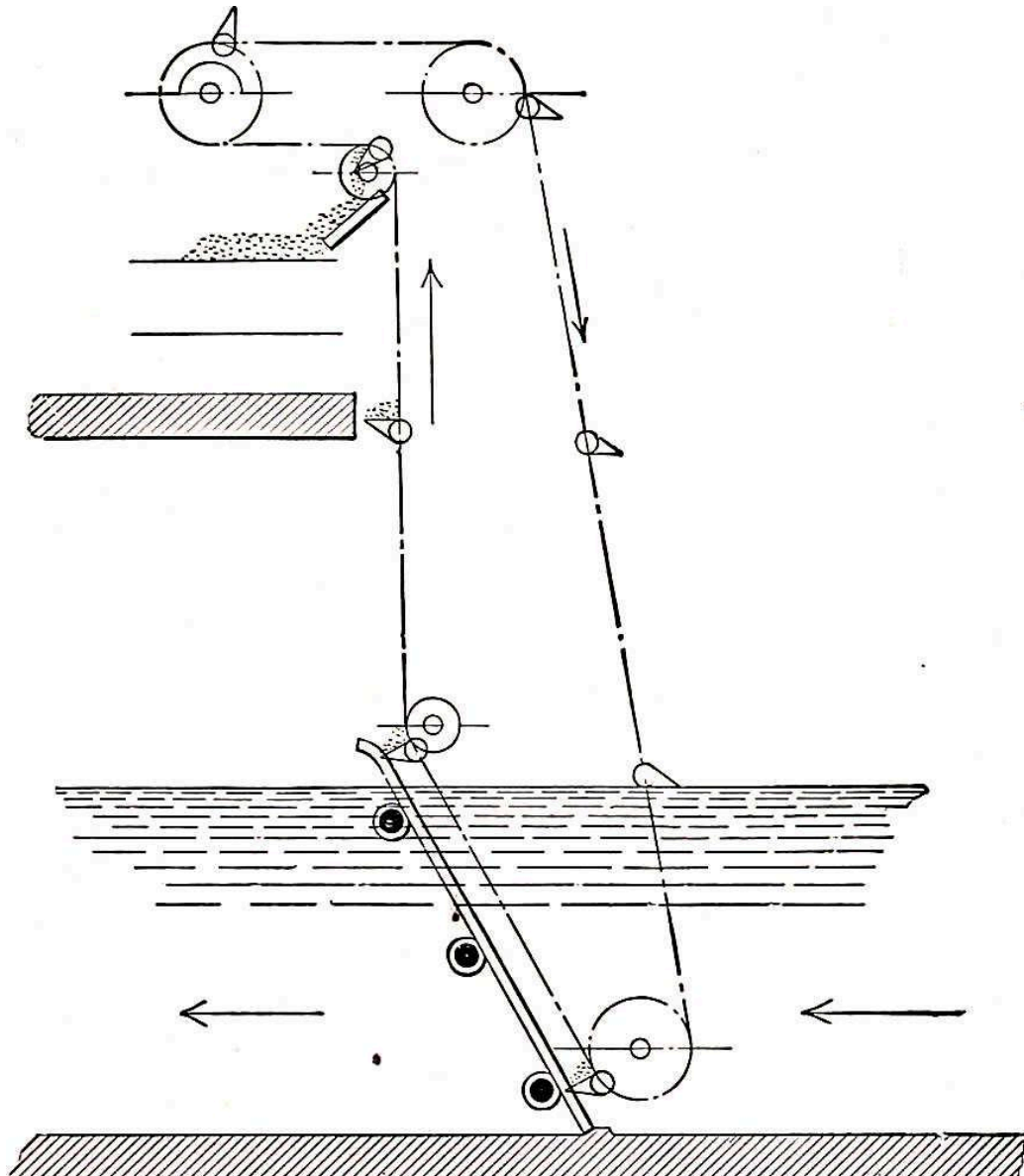

ETP / STP / WTP / DESALINATION

SCREENS FOR ETP STP WTP

MANUAL to FULLY AUTOMATIC with COMPACTORS



WHIRLER CENTRIFUGALS PVT LTD, *MAKING IN INDIA SINCE 1980*

Office : L605, GIDC, Odhav, Ahmedabad 382415, Gujarat, India

Works : 13,14 Industrial Estate, Varsola, Mahemdabad, Kheda 387130, Gujarat, India.

- Separation Division : +91 9426419038, +91 9909960911, +91 9033723683

Email : info@whirlercentrifugals.com

Do Not Print. Save The Environment.



STEP SCREEN

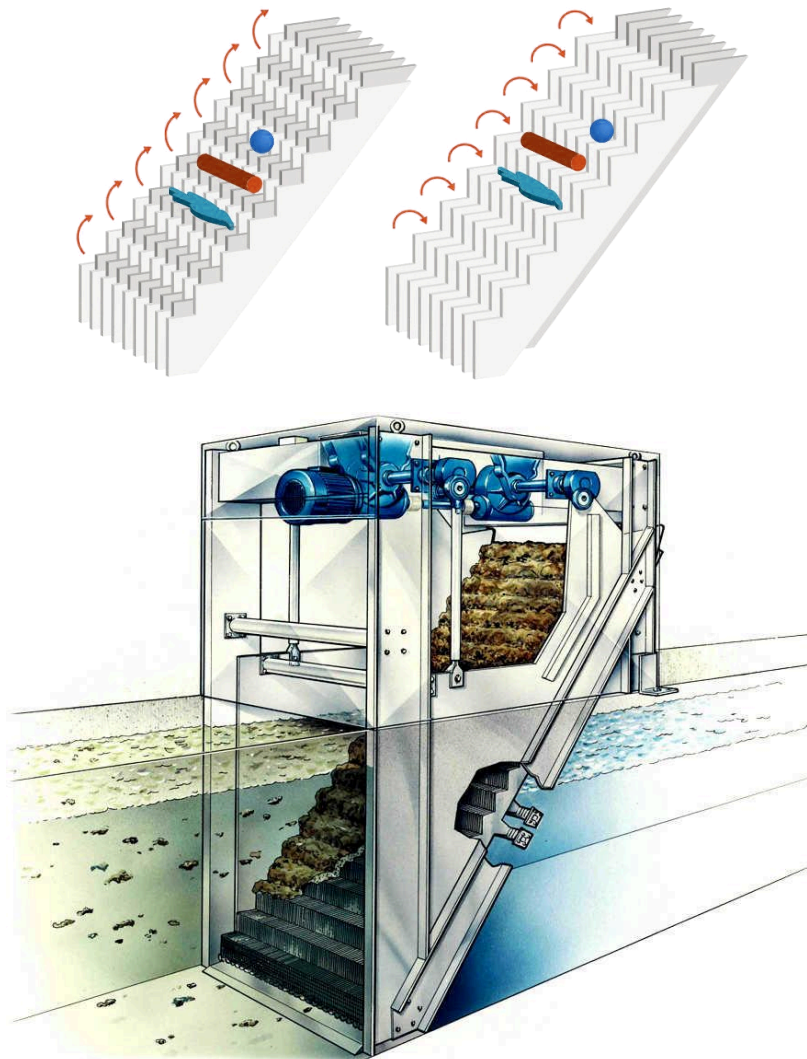

Type	Unit	WS-1000	WS-1500	WS-2000	WS-2500	WS-3000
Width	mm	600	600	800-1000	800-1000	800-1000
Height	mm	450	600	800	1000	1400
Side water depth (SWD)	mm	650	850	950	1200	1700
Bar Space	mm	1 - 6	1 - 6	1 - 6	1 - 6	1 - 6
Max.flow*	MLD	0.5-1	1-2.5	2.5-4	4-6	6-10
Discharge Height	mm	700-1200	1200-2000	1200-2000	1200-2000	1200-2500
Effective Width	mm	300	600	600	800	800

- Max flow in liters per second subjected to clear water at 0.2 meter head and 3 mm bar space.
- Minimum velocity 0.45 m/s to prevent clogging, max. 0.90m/s to prevent washout.



MULTI RAKE BAR SCREEN

Multi rake bar screen is a mechanically cleaning screen which is installed in the inlet works of treatment plants, pumping stations and water inlet structures to capture solid materials which otherwise would be harmful to following processes and to the downstream equipment. Clogging possibility is minimized by using several rakes which are lined on a pair of endless chains instead of one rake which is operated by an arm. Screen opening can be manufactured up to 5 mm, so it can be efficiently used for fine screening applications which need small screen opening.

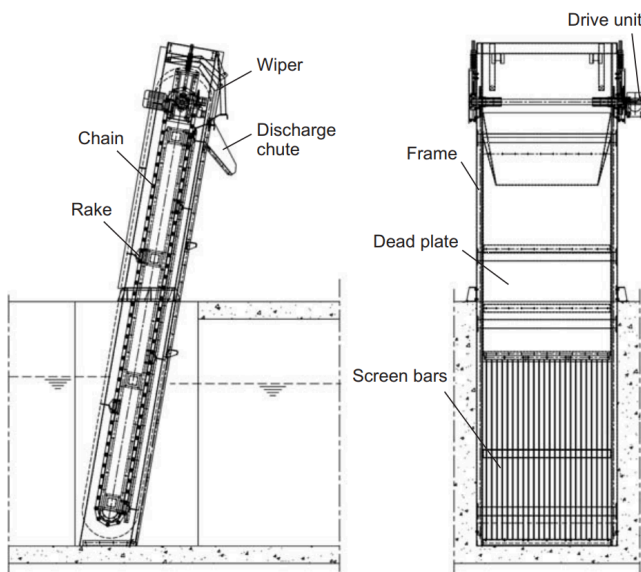

Construction:

1. Screen frame : Fabricated with MOC option of SS / Galvanised Steel / MSEP
2. Dead Plate : SS Formed and Joined by Bolting.
3. Screen Bars : Trapezoidal or Rectangular, in MS or SS
4. Discharge chute : For Solid Capture, in MS or SS
5. Rake : MS or SS, mounted on an endless SS Chain, with Friction Reducing PE Ends.
6. Wiper : SS with PE Edge for Cleaning and Discharging of Solids from Rake
7. Chain : Two Sprockets, Two Endless Chain in SS for trouble free operations.
8. Drive : IP55 Class motor with Standard Gearbox



Design Options:

1. Screen channel width : 600 - 1200 mm
2. Screen channel depth : up to 5000 mm
3. Discharge height : 800 mm - 2500 mm
4. Bar extension : 200 mm
5. Screen opening : 5 - 50 mm
6. Installation angle : 70 - 80 degree
7. Rake travel speed : 4 - 8 m/min
8. Accessories:
 - a. Torque switch
 - b. Ultrasonic differential level measurement
 - c. Local control panel
 - d. Cover

ROTARY DRUM SCREEN

ROTARY DRUM SCREEN, compared to other screening technologies, is primarily used for fine screening, usually fibers and other bio sludge. Drum Screen can be made very fine to **separate solids up to 0.1 mm and more**. Drums are either perforated sheets or sometimes wire wedge screens, installed on a slant rotating support (trunnion wheels) with internal screw to convey solids on one side and liquid on the other.

Applications:

Subset industries where Drum Screen used.

- Paper and pulp industry separation of fine fibres
- Meat processing industry: separation of scraps
- Agricultural industry
- Breweries preliminary treatment of process waters
- Laundries, separation of fibres from wash waters

Construction:

Our drum screens come in many sizes /custom made for different flows, thus ensuring that one or more units are suitable for each application.

- Material of Construction : AISI 316
- Perforation Size : 1 mm Standard
- Drum Thickness : 0.5mm up to 6.0mm
- In to Out, Out to In Option
- With or without an overflow system.
- VFD Speed Controls (Optional)
- Variable inclination (Optional)
- Low weight and small built-in dimensions for easy installation.
- Optional Accessories :
 - Solid Pressing Screw in the output
 - High Pressure Washing Pump

